

D4-180I-E, D4-225A-E, D4-225I-E, D4-260A-E, D4-260D-E, D4-260I-E, D4-300A-E, D4-300D-E, D4-300I-E

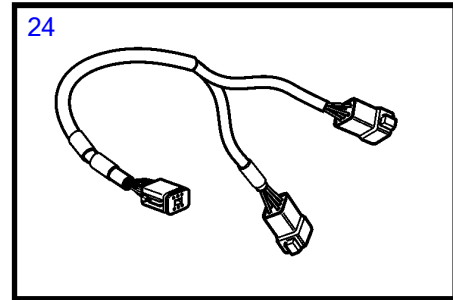
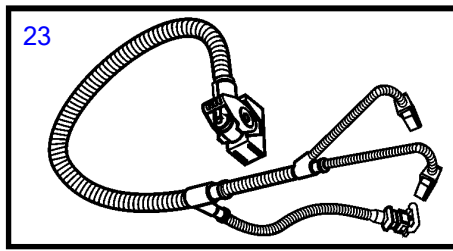
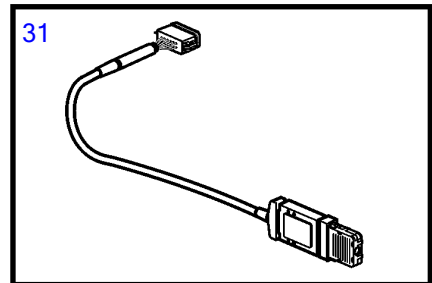
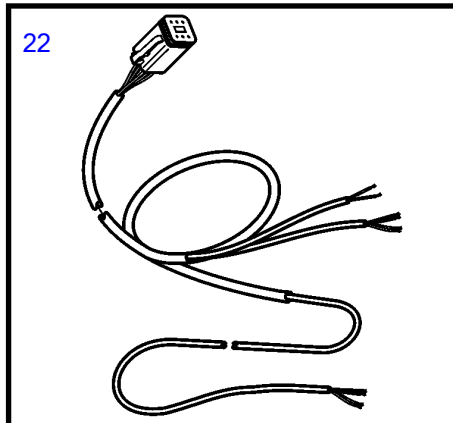
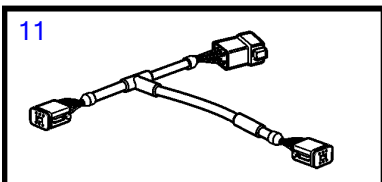
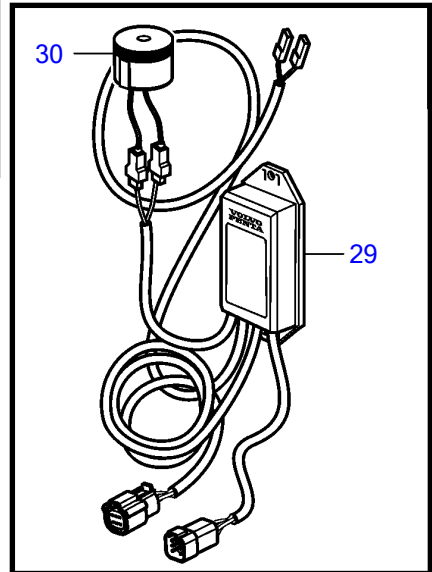
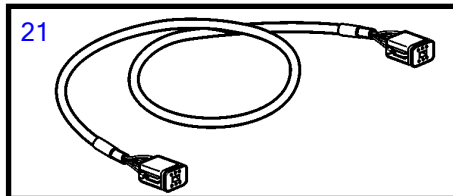
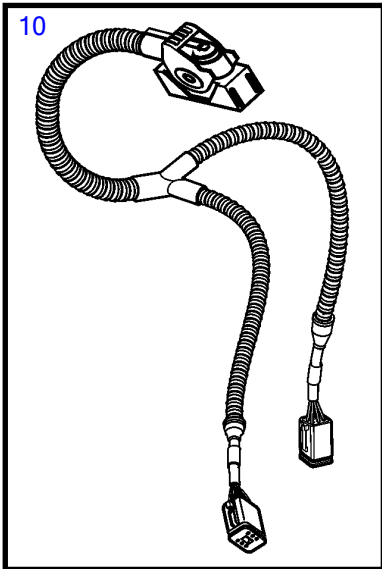
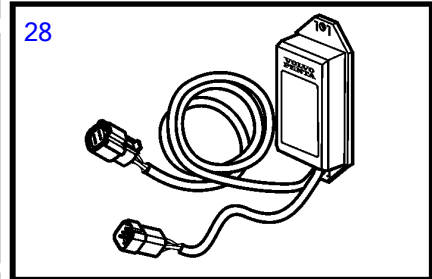
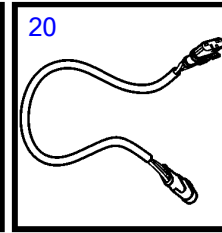
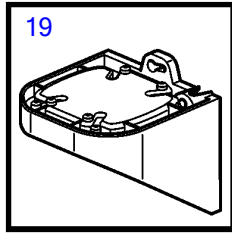
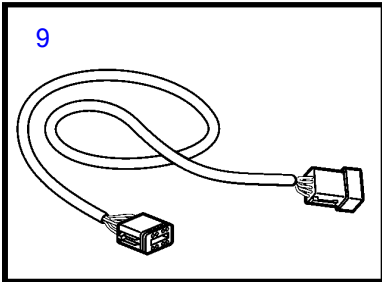
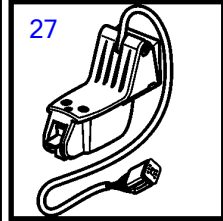
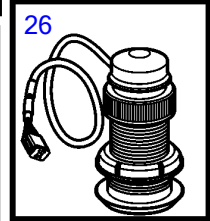
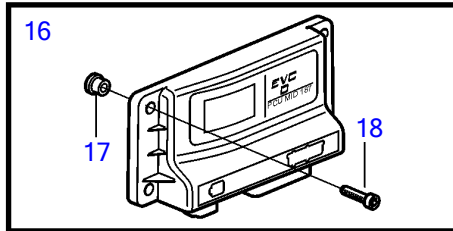
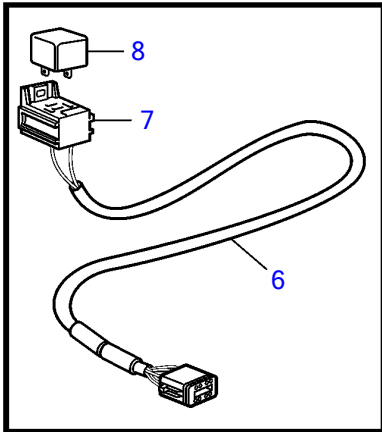
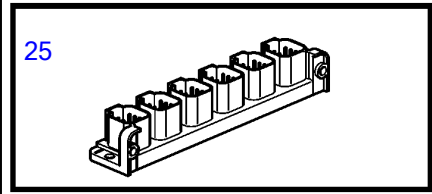
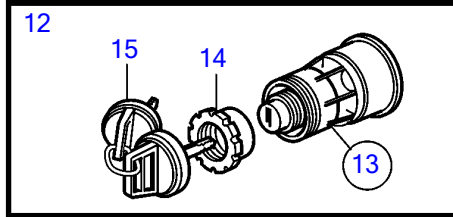
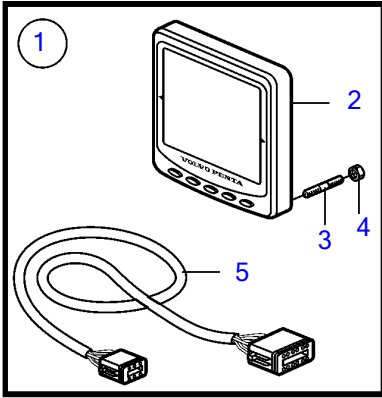

26409

D4-180I-E, D4-225A-E, D4-225I-E, D4-260A-E, D4-260D-E, D4-260I-E, D4-300A-E, D4-300D-E, D4-300I-E

REF	PART NO.	QTY	DESCRIPTION	SEE SEC.	NOTES
1	21352262	1	Display		Replaced by 21631438
	21631438	1	Kit		
2		1	• Display		
3	830928	4	• Stud		
4	830930	4	• Wing nut		
5	3588207	1	• Cable kit		
6	21427463	1	Cable		Relay cable. 6-pin. L=1,5m
7	977184	1	Housing		
8	873765	1	Relay		12V
	3171420	1	Relay		24V
9	3889410	1	Extension cable'verl		L=1.5m, DPH-B
	3842733	1	Extension cable'verl		L=3.0m
	3842734	1	Extension cable'verl		L=5.0m
	3842735	1	Extension cable'verl		L=7.0m
	3842736	1	Extension cable'verl		L=9.0m
	3842737	1	Extension cable'verl		L=11.0m
	21172469	1	Extension cable'verl		L=20m
	21172470	1	Extension cable'verl		L=40m
10	40005754	1	Wiring harness		Engine-PCU cable., L=2.65m
11	3588972	1	Cable kit		T-connector bus cable, 6-pole., L=0.5m
12	3587070	1	Starter switch, set		Kit with 2 key switch with identical key.
13	3587071	1	Starter switch		
14	859955	1	• Plastic nut		
15	859953	1	• Key		State key code when ordering
			• Bulletin 49-30	49-30-EN	Key P/N 859953
16	21469059	X	Control unit, not programmed		PCU. Software ordered separately or downloaded with Vodia.
	3586267	X	Software		Warehouse programming. This p/n can not be ordered, but will be used for invoicing.
	3586266	X	Software		Vodia-programming. This p/n can not be ordered, but will be used for invoicing.
17	21230875	4	• Sleeve		
18	976104	4	Flange screw		
19	21520222	1	Control unit		HCU. separate mounting, Software ordered separately or downloaded with Vodia.
	3586259	1	Software		Vodia-programming. This p/n can not be ordered, but will be used for invoicing.
	3586261	1	Software		Warehouse programming. This p/n can not be ordered, but will be used for invoicing.
20	874759	1	Extension cable'verl		
	3807043	1	Extension cable'verl		
21	3886666	1	Cable, synchronizing		Syncronizing cable for twin installation. 6 pole., L=1.5m
22	3807229	1	Wiring harness, fuel		
23	40005753	1	Wiring harness		Transmission cable for reverse gear
24	3588206	1	Cable kit, y-split		For connecting extra equipment to Multilink
25	21469055	1	Connection block		
26	3587054	1	Sensor		Through hull
27	3587055	1	Sensor		Mounted on transom
28	21460908	1	Converter		
29	21461496	1	Network adapter		Analogue key interface
30	3817974	1	• Alarm		
31	21509941	1	Control unit		

7746200-30-36145

27251

Upd:2014-07-03